

Rose Thread Tension Class

*Bernt Ståhl, Husqvarna Factory
Las Vegas, July 1998*

Contents

Lower thread tension (thread tension of the bobbin case)	3
Upper thread tension	4
Upper thread tension	5
Coarse adjustment	6
Dismount the upper rear cover.....	7
Dismount the lower rear cover	8
Front cover	9
Circuit board - Circuit diagram- Dismounting	10
Coarse Adjustment of upper thread tension.....	11
Thread tension Mounting instruction	14
Mount the PC-Board	16
Mounting front cover.....	17
Mounting the lower rear cover.....	18
Mounting the upper rear cover	19
Test Sew	20

Lower thread tension (thread tension of the bobbin case)

Check

1. Insert a full bobbin into the bobbin case.
2. The thread tension spring of the bobbin case shall give a resistance of 12 - 20 g when pulling the thread slowly.

Adjustment

1. Turn screw (A) until the correct thread tension is obtained.

NOTE! Before any adjustment is made remove any loose pieces of thread or fluff from the thread tension discs

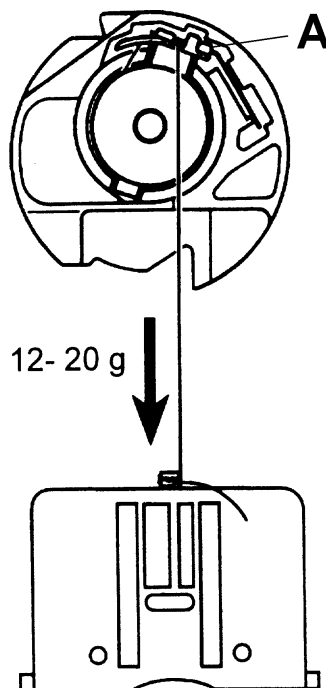

Upper thread tension

To facilitate the setting of the upper thread tension there is an electronic adjustment in the normal function position.

Operation

Switch on the main switch. Then select one of the following combinations.

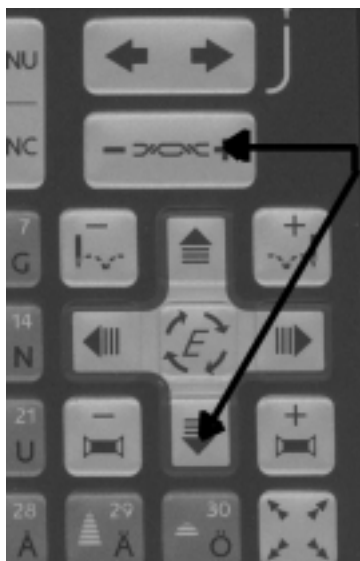

NORMAL THREAD TENSION

Embroidery key (↓) arrow down and (+) thread tension key plus. Is used at fine adjustment of the upper thread tension at normal position .
Instead of a stitch number TT is shown on the display and instead of the stitch length a setting value.

EMBROIDERY THREAD TENSION

Embroidery key (↓) arrow down and (-) thread tension key minus. Is used at fine adjustment of the upper thread tension at embroidery position .
Instead of a stitch number TC is shown on the display and instead of the stitch length a setting value.

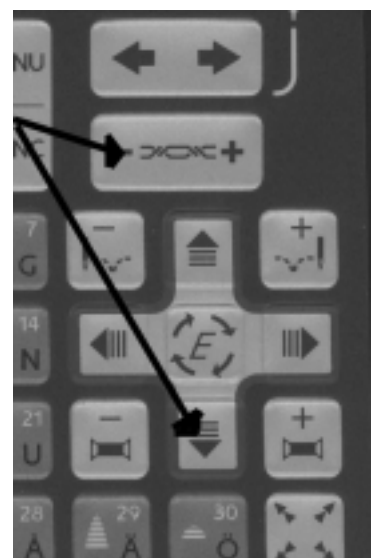

Upper thread tension

NOTE! Before any adjustment is made look for loose pieces of thread or fluff inbetween the thread tension discs. And If there are any remove it.

A correct thread take-up should be obtained at straight stitching and zigzag in cotton when the thread tension dial is set within the marked area.

Fine adjustment

Switch on the machine.

1. Press the embroidery key (↕) and the thread tension key (+) simultaneously. Instead of a stitch number TT is shown on the display, and instead of the stitch length a setting value. The value can be set between +6 and -6. The value on the display is changed gradually each time you press the key. The machine will always remember the most recently set value.

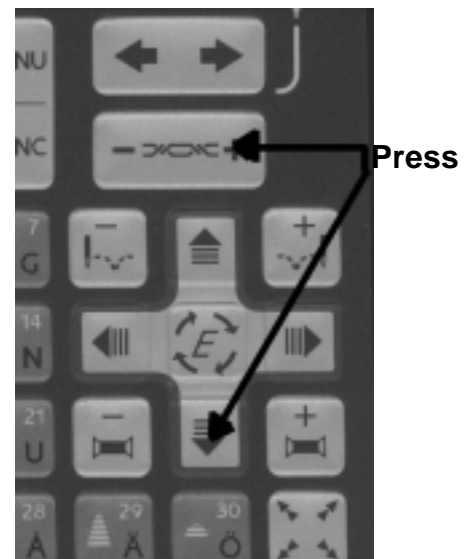

2. Sew and press the (+) or the (-) of the stitch length key until a correct take-up is obtained. If you wish a harder thread tension press the stitch length key (+). If you wish a softer thread tension press the stitch length key (-).

3. To save, press any key, but not the stitch length key.

NOTE! Before any adjustment is made remove any loose pieces of thread or fluff from the thread tension discs

Coarse adjustment

If a correct take-up is not obtained with the fine adjustment. Switch on the machine. Press embroidery key (↵) and the thread tension key (+) simultaneously and **ZERO (0)** the fine adjustment.

To save, press any key, but not the stitch length key.

NOTE! Before any adjustment is made remove any loose pieces of thread or fluff from the thread tension discs.

Dismount the upper rear cover

1. Remove the two screw's (A) under the handle.

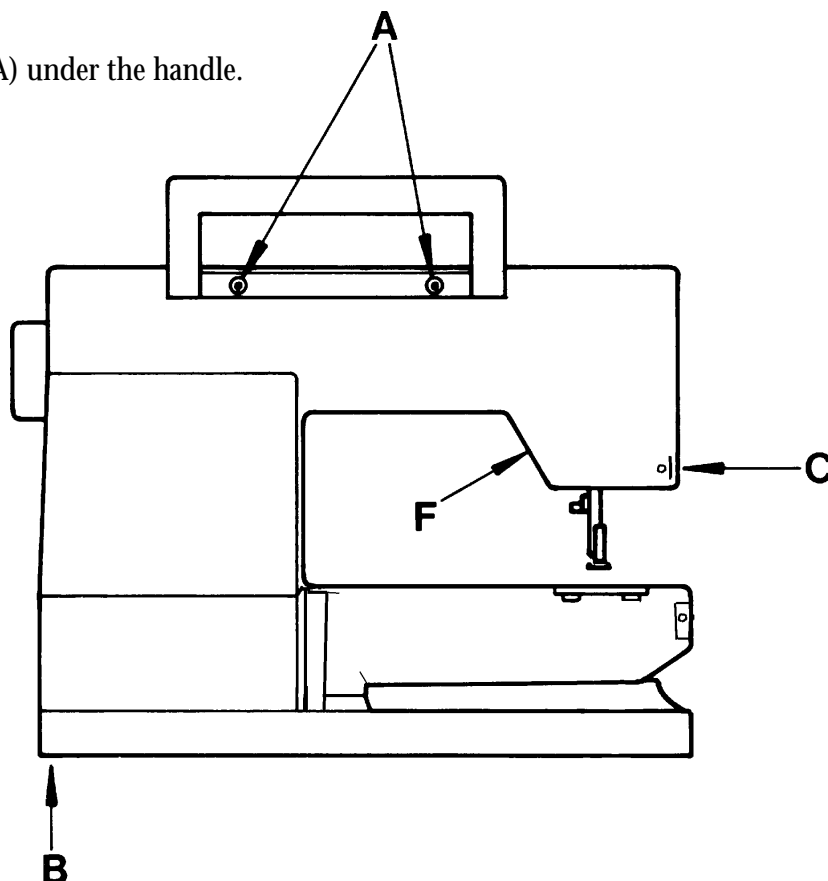

2. Remove the screw (B) in the rear corners of the base plate
3. Remove the screw (C) at the thread knife of the Sewing head.
4. Expose the hook (F).
5. Raise the presser bar.
6. Remove the rear cover by pushing out the lower right side of the cover and then pull the cover straight back.

Dismount the lower rear cover

1. Remove screw (E).

2. Cautiously bend with a screwdriver in the two socket's (D) under the stitch plate in order to expose the hook.

3. Remove the lower rear cover.

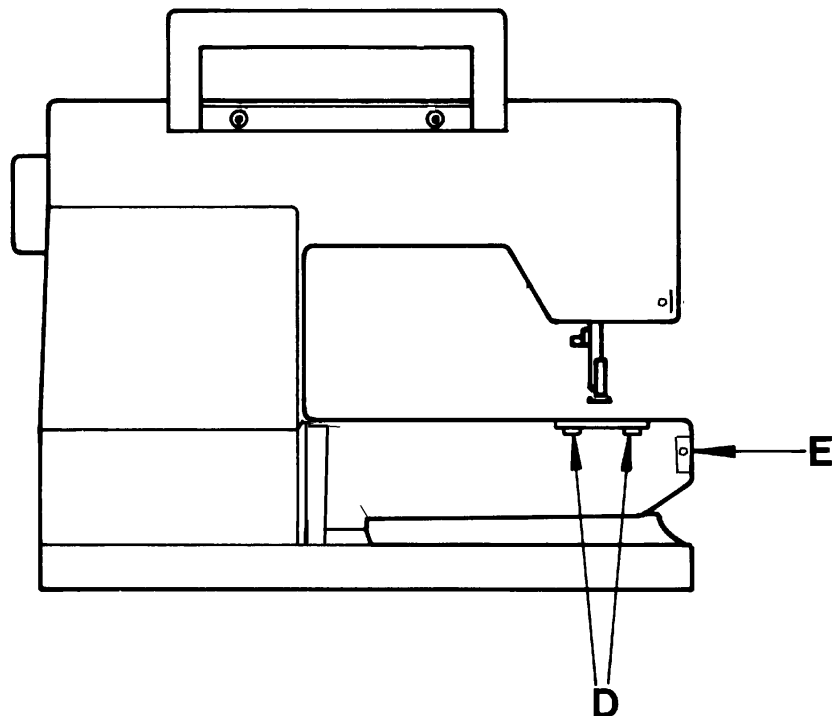

4. Remove the embroidery connector from lower rear cover by pushing the connector from the outside.

NOTE ! Use wrist band

Front cover

1. Loosen the button for the off-switch, winding (A), by pulling it straight out.

2. Remove the two screw's (B) from behind.

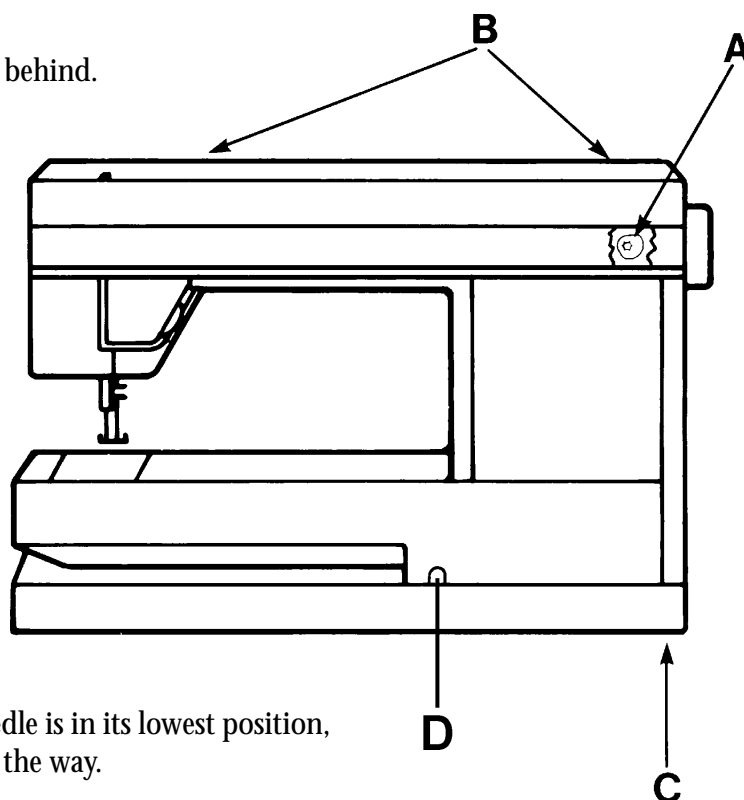

3. Turn the hand wheel until the needle is in its lowest position, so the thread take up lever is out off the way.

4. Carefully bend away the front cover from the hand wheel,

5. Remove the front cover while holding a finger on the cover (D) until it pops out, lift the cover over the connector sensor and the step motor cables. Then pull it down and out off the hook cover .

5 .Remove the band cable of the foil keyboard from the circuit board by pulling the outer covering of the white switch outwards.

Circuit board - Circuit diagram- Dismounting

NOTE ! Use wrist band

1. Remove the 3 screws (A) holding the circuit board and the cooling plates

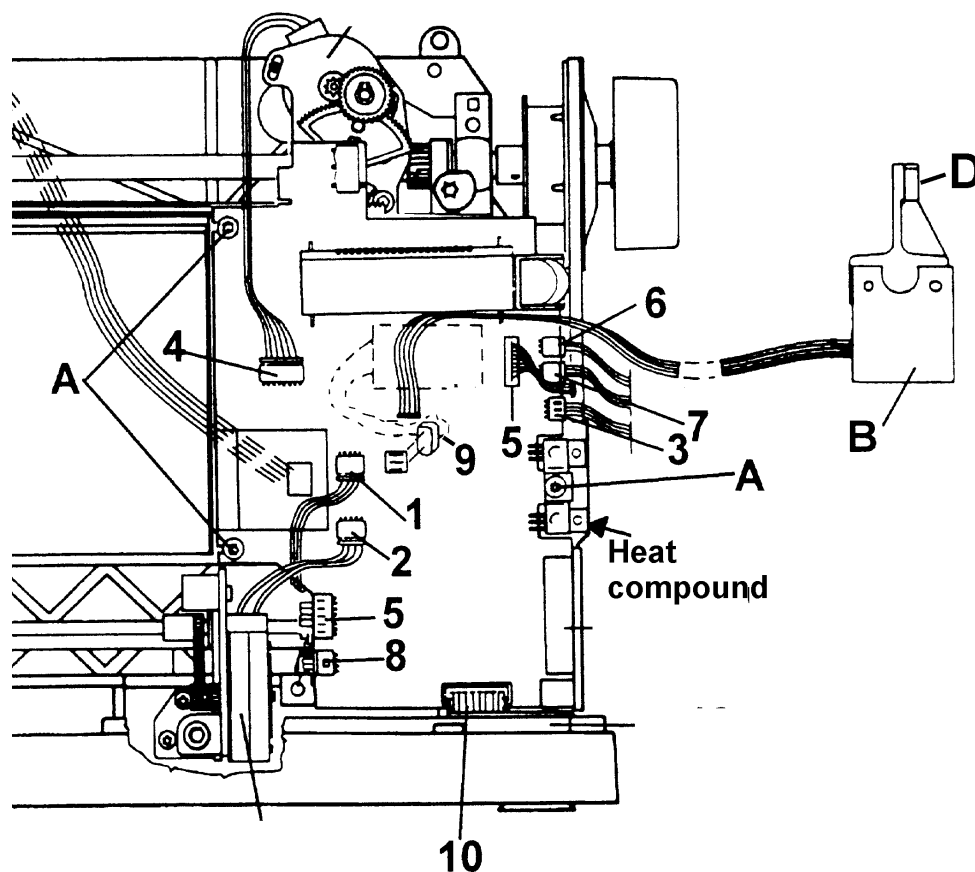

2. Loosen the cable (4) The step motor of the thread tension from the circuit board.

3. Remove the board partly out a bit from the machine.

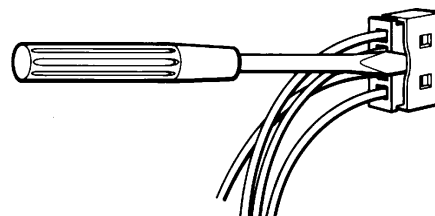

Coarse Adjustment of upper thread tension

1. Remove C-washer (C).
2. Remove Washer (D)
3. Remove cog segment (H).

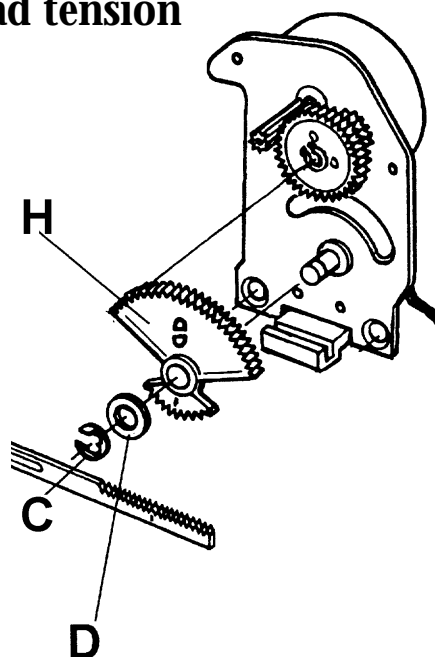

4. Remove the screws (I) of the thread tension unit and partly remove it.

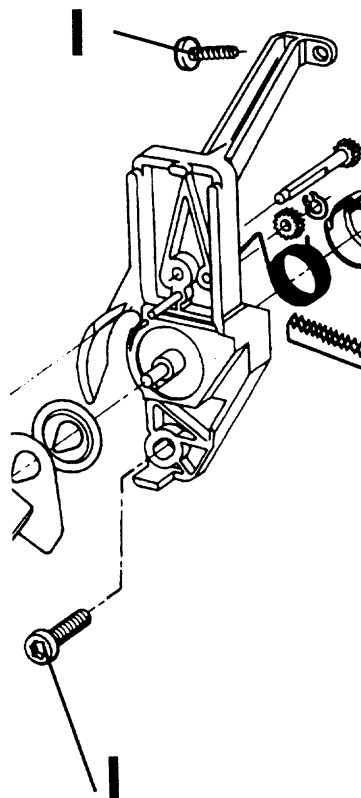

1. Remove the locking washer (I).
2. Remove the cogwheel (J).

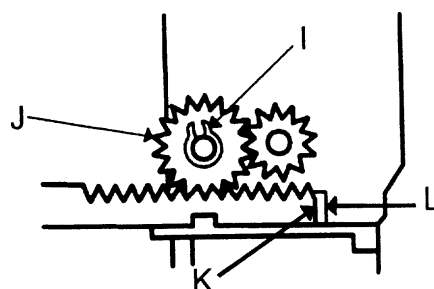
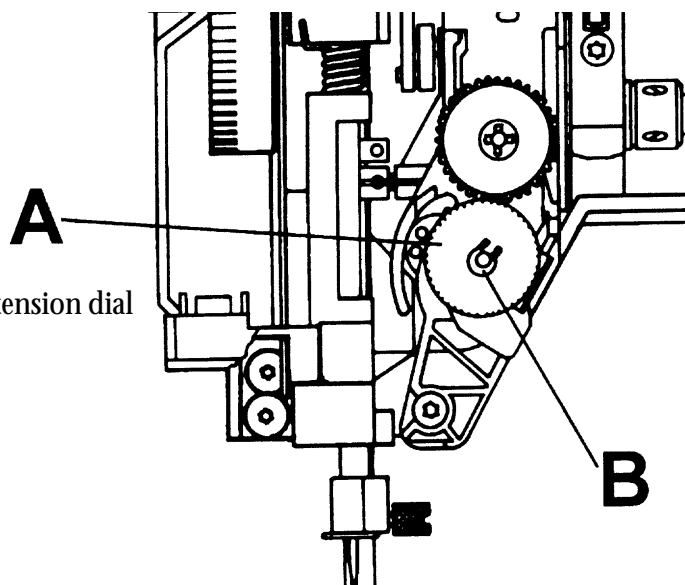
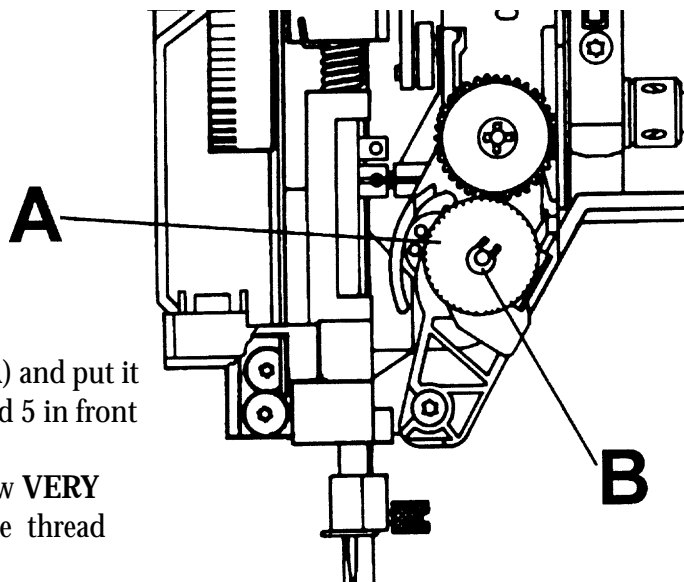

Fig 1

3. Mount the thread tension unit.
4. Mount the PC -board
5. Sew the machine and turn the thread tension dial (A) until a correct take-up is obtained.



1. Remove locking washer (B).



2. Remove the thread tension dial (A) and put it back on the shaft in-between 4 and 5 in front of the index.
NOTE At this movement It is now **VERY** important that you **don't** move the thread tension dial.

3. Remove the screws (I) of the thread tension unit and partly remove it

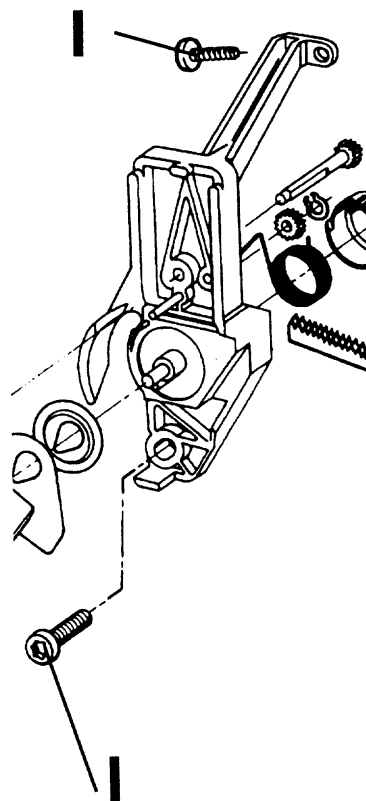

Thread tension Mounting instruction

1. Place the edge of the rack (K) right above the index mark (L) of the thread tension casing according to fig 1.

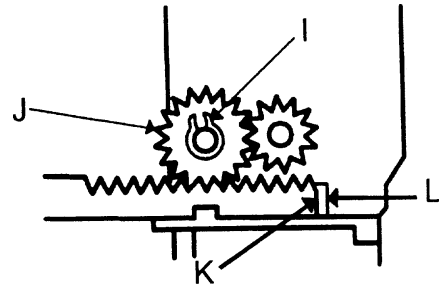

2. Mount the cogwheel (J) and the locking washer (I).

3. Mount the thread tension unit.

1. Place the index mark (M) of the rack right in front of the index mark (O) of the step motor.

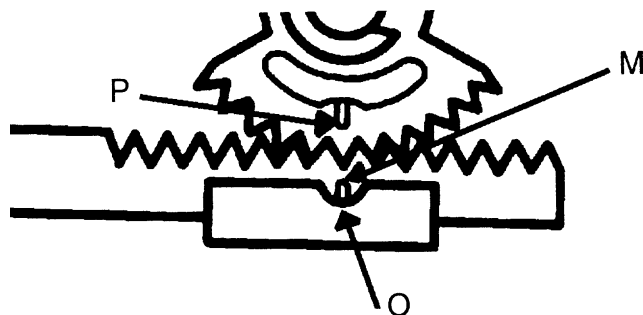

2. Place the index mark (P) of the cog segment (H) right in front of the index mark (M) of the rack.

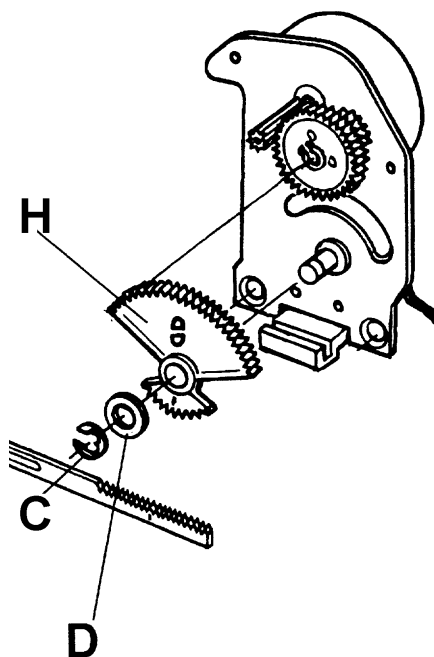

3. Mount washer (D) and C-washer (C).

Mount the PC-Board

1. Reattach the PC-board.

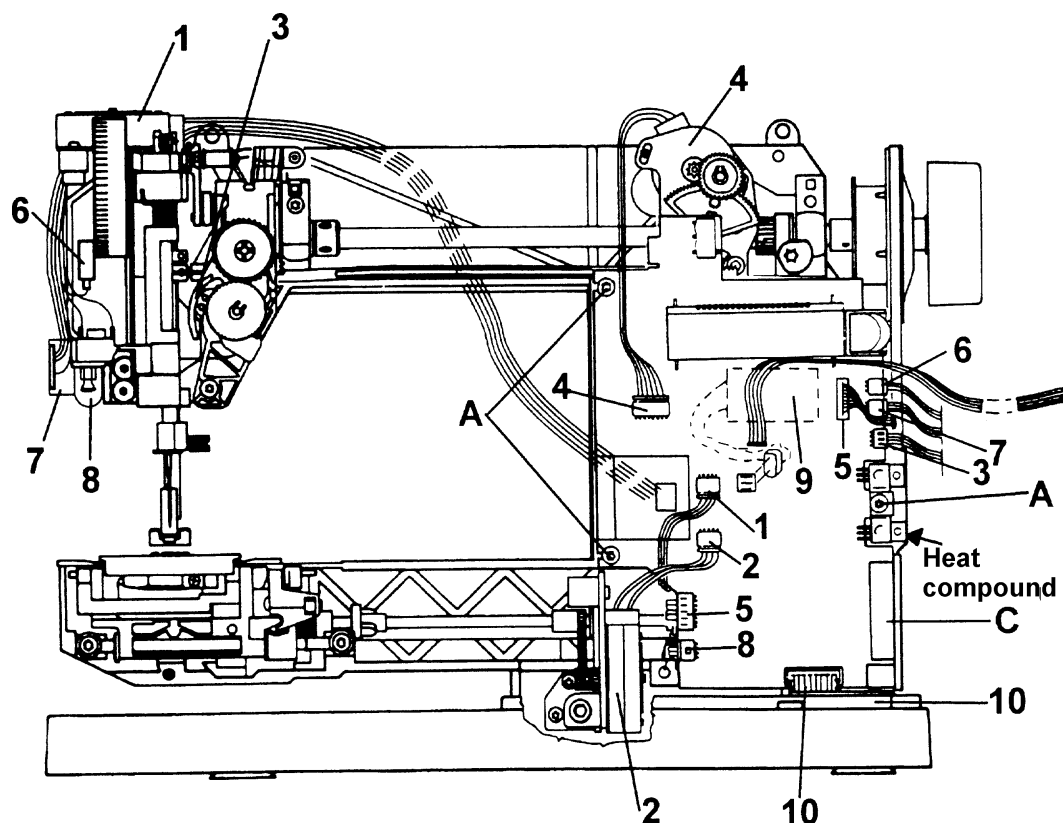

2. Mount the cable from (4) The step motor of the thread tension to the circuit board.

3. Mount the 3 screws (A) holding the circuit board and the cooling plates

Mounting front cover

1. Attach the band cable of the foil keyboard to the circuit board and push in the outer covering of the white switch.
2. Turn the hand wheel until the needle is in its lowest position, so the thread take up lever is out off the way.
3. Slide the cover in the hook cover and lift it over the connector sensor and the step motor cables and push it in its correct position.

4. Mount the two screw's (B) from behind.

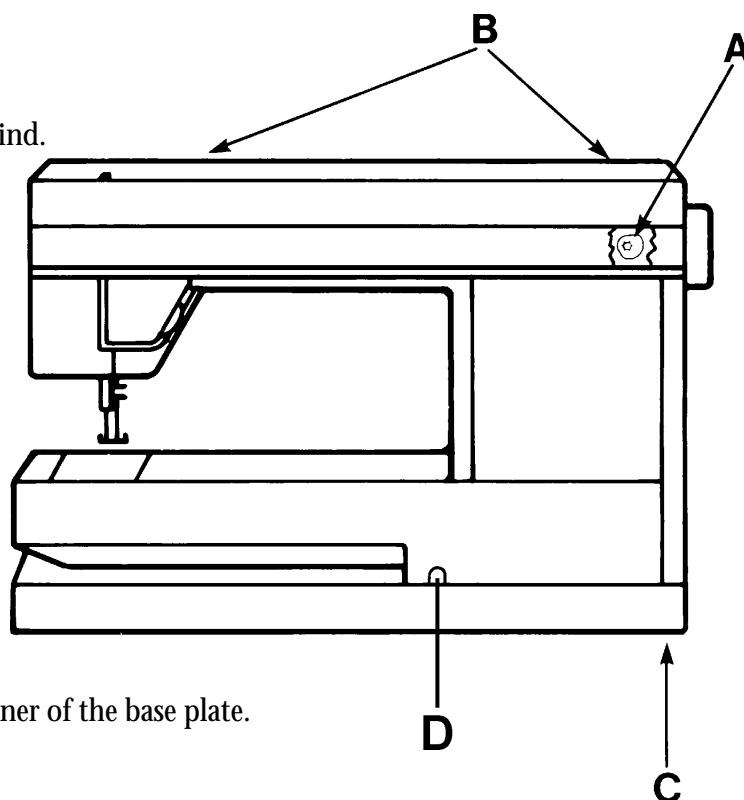

5. Mount the screw (C) in the front corner of the base plate.
6. Attach the button for the off-switch, winding (A), by pushing it straight in.
To set the bobin winding stop you can use a pre-made correctly winded bobbin.
7. Snap on cover (D).

Mounting the lower rear cover

1. Insert the embroidery connector in the lower rear cover.

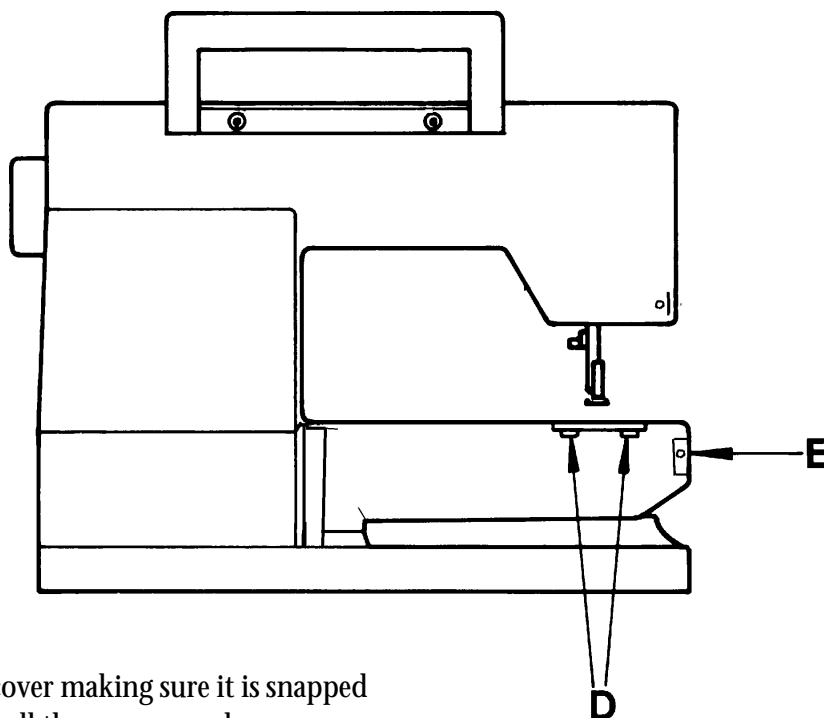

2. Attach the lower rear cover making sure it is snapped on in it's correct position all the way around.

3. Insert screw (E).

Mounting the upper rear cover

1. Raise the presser bar,

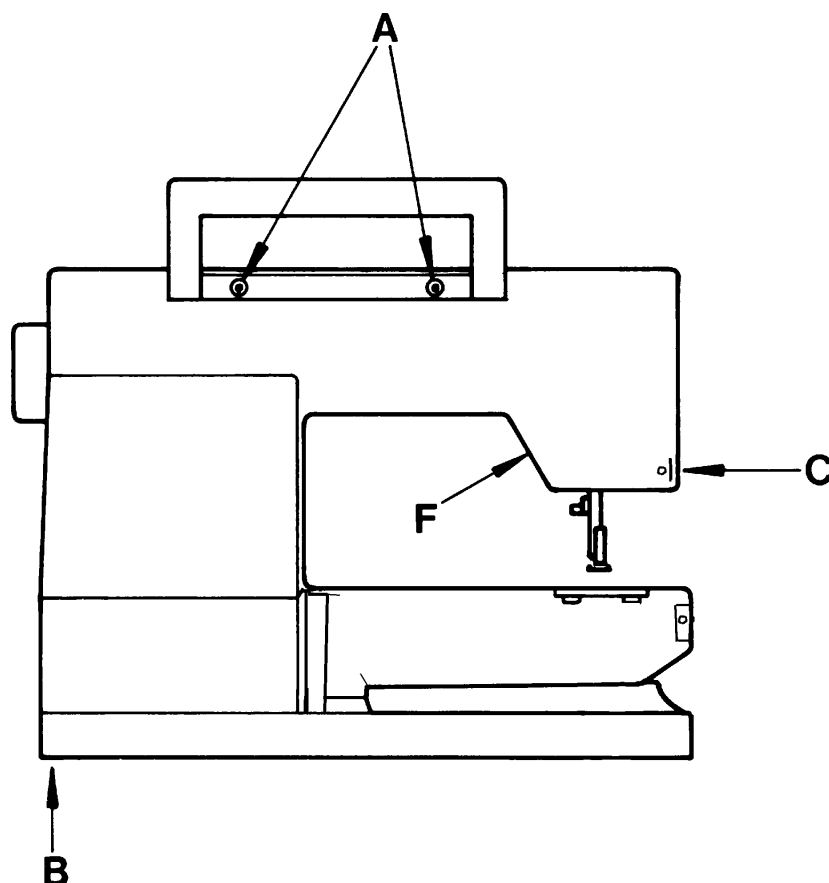

2. Mount the cover by first snapping on the hook and then the top of the cover working your way around to the bottom.
3. Mount the two screw's (A) under the handle
- 4 . Mount the screw (B) in the rear corner of the base plate
5. Mount the screw (C) at the thread knife of the Sewing head.

Test Sew

Dont Forget to test sew the machine.

Service stitch # 18 - The pre-programmed mending stitch (only in the service mode)

Straight Sticking 2,5 mm
4 mm
6 mm

Z-Z 4X4 mm
 6x6 mm

Buttonhole At least one type of the machines buttonhole

Since this is a Embroidery machine dont forget test sewing also this.